

GPE 5/8 GPS 1/2

26.4.....29 MHz Tunable Base Station Antennas

SPECIFICATIONS

Electrical Data

Type	: GPE 5/8.....5/8 λ Ground Plane
	: GPS 1/2.....1/2 λ end feed dipole
Frequency range	: 26.4...29.0 MHz tunable (see table)
Impedance	: 50 Ω
Radiation (H-plane)	: 360° omnidirectional
Polarization	: Linear Vertical
Gain	: GPE 5/8.....1.2 dBd, 3.35 dBi
	: GPS 1/2.....0 dBd, 2.15 dBi
Bandwidth @ SWR ≤ 2	: ≥ 1600 KHz
SWR @ res. freq.	: ≤ 1.3
Max Power	: 250 Watts (CW) continuous
	: 750 Watts (CW) short time
Feed system/ position	: Transformer DC-ground / base
Connector	: UHF-female

Mechanical Data

Materials	: Aluminium, Steel, Copper, Nylon
Wind Load/Resistance	: 160 N @ 150Km/h / 130 Km/h
Wind surface	: 0.12 m ²
Length (approx.)	: 5950 mm both models
Weigth (approx.)	: GPE 5/8.....2500 gr
	: GPS 1/2.....2100 gr
Radial lenght	: 1320 mm (GPE 5/8 only)
Mounting Mast	: \varnothing 35-42 mm

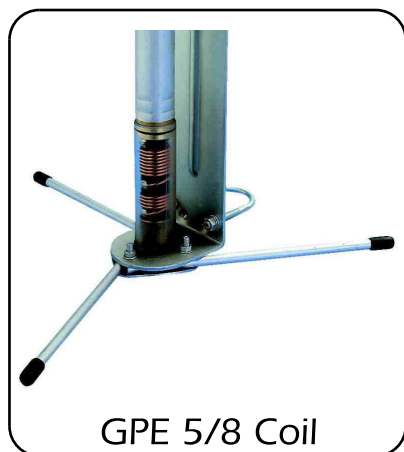

GPE 5/8 Coil



GPS 1/2 Coil

WARNING

INSTALLATION OF THIS PRODUCT NEAR POWER LINES IS DANGEROUS. FOR YOUR SAFETY AND BEFORE YOU BEGIN INSTALLATION, READ THE SEPARATE SAFETY INFORMATION SHEET.

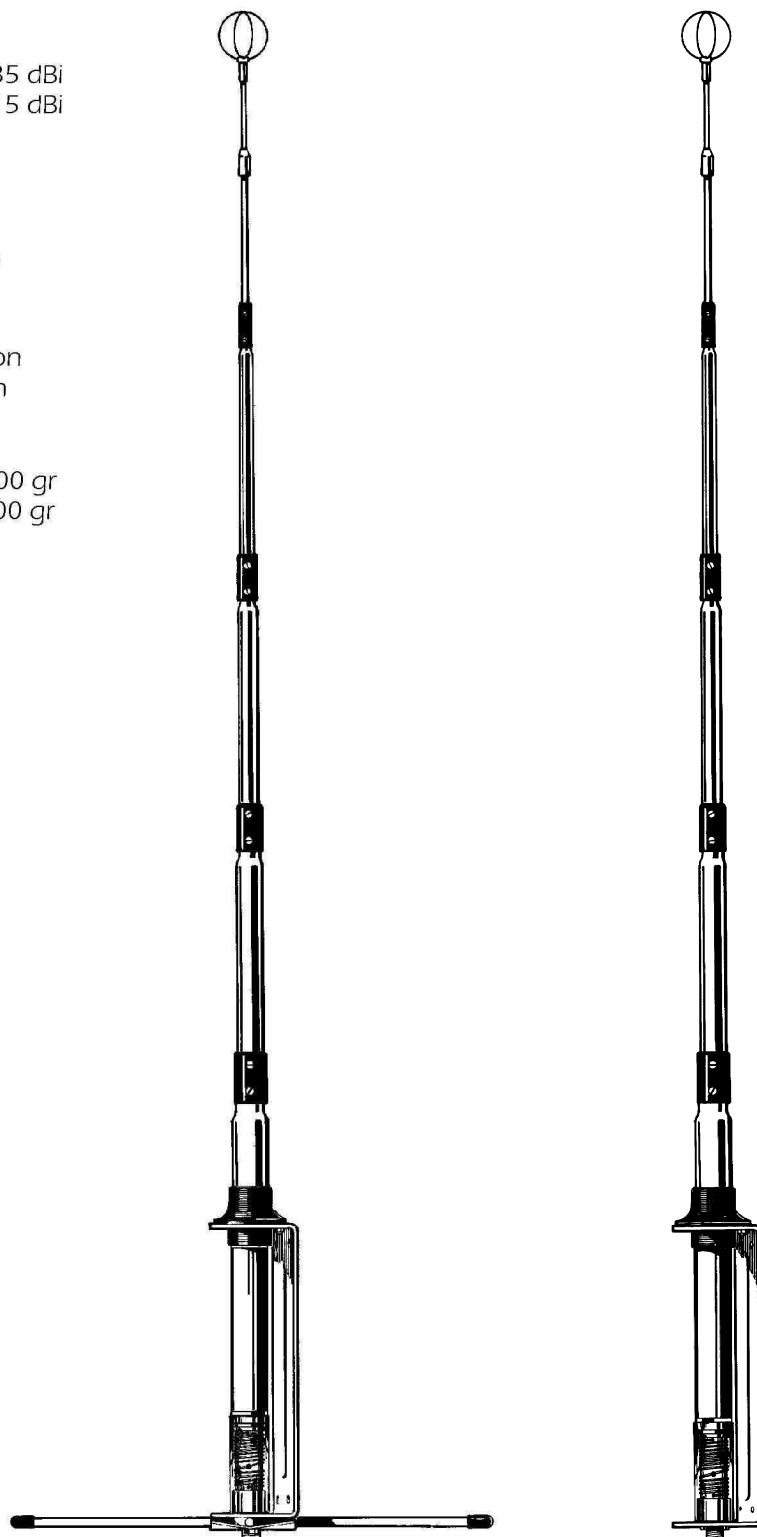

GPE 5/8

GPS 1/2



SIRIO
antenne

HI-QUALITY ANTENNAS MADE IN ITALY

TUNING TABLE

Freq. (MHz)	GPE 5/8 L (mm)	GPS 1/2 L (mm)
26.4	850	900
27.0	642	745
27.185	600	660
27.5	487	562
28.0	340	395
(10 m band) 28.5	183	228
29.0	15	60

Mounting needed tools:

- n. 1 tape rules (meter)
- n. 1 phillips screwdriver
- n. 1 10 mm open key
- n. 1 19 mm open key

Additional tools for GPE 5/8:

- n.1 flat screwdriver
- n.1 8 mm open key

Parts List

Pos	Q.ty	Description
1	1	5 sections telescopic aluminium whip with coil
2	4	plastic jointing sleeves (4 different sizes)
3	8	Ø 3.9x6.5 phillips tapping screws
4	1	top section with cage
5	1	M4x4 hexagon socket set screw cup point
6	1	2mm hexagonal key
7	1	Rubber washer
8	1	M16 spring lock washer
9	1	19mm hexagonal nut
10	1	steel bracket
11	4	M6 washers
12	4	M6 spring lock washers
13	4	M6 hexagonal nuts
14	2	M6x160mm U-bolt
GPE 5/8 additional parts:		
15	3	Ø 6x8x1320mm aluminium tubes
16	1	Metal Plate
17	3	M5x25 screws
18	3	M5 washers
19	3	M5 hexagonal nuts
20	3	PVC cap for Ø 8mm aluminium tube

MOUNTING INSTRUCTIONS

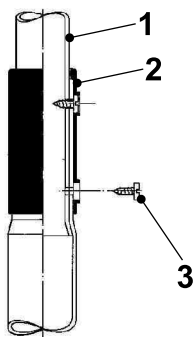

Pull out the sections of telescopic aluminium whip (1), insert the jointing sleeve on the tubes (2) and lock they using the phillips screws (3).

1

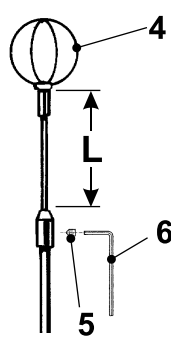

Insert the top section with the cage (4) at L (see tuning table for frequency) and lock it using the screw (5) and 2mm hexagonal key (6).

NOTE: Use the table just as a guide. For fine-tuning please use an SWR-meter

2

3

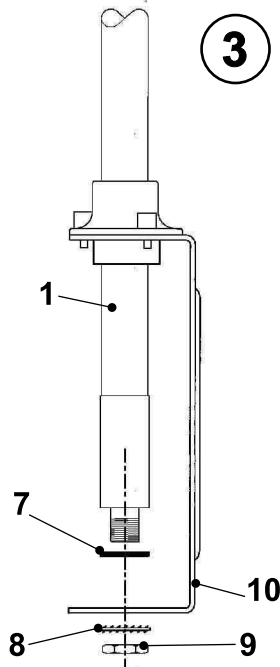

Mount the antenna on the mast using parts (11) (12) (13) (14) in according to the picture.

4

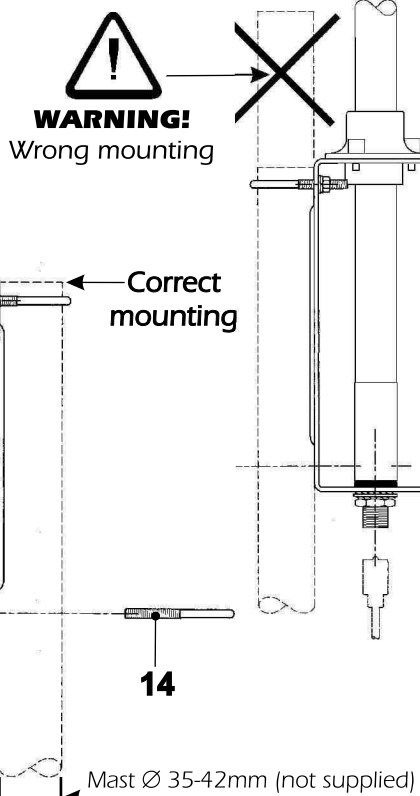

WARNING!
Wrong mounting

Correct mounting

Mast Ø 35-42mm (not supplied)

Fit the rubber washer (7) on the bottom of antenna (1). Well lock washer (8) and nut (9) to the steel bracket (10) by using the suitable 19mm key.

Radials mounting GPE 5/8 ONLY

5

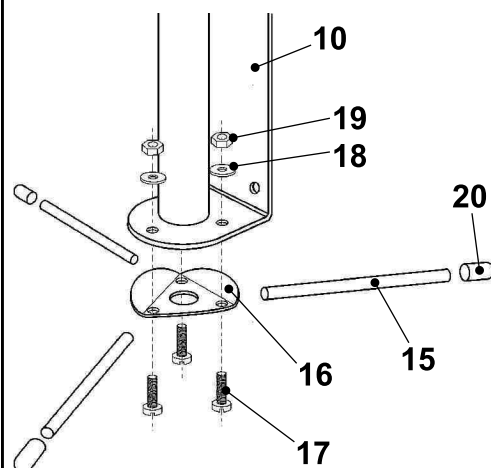

Place the aluminium radials (15) between the steel bracket (10) and the metal plate (16) in according to the picture and lock they by using the supplied screws (17) washer (18) and nut (19). Finally mount the PVC cap (20).



SIRIO
antenne

HI-QUALITY ANTENNAS MADE IN ITALY